

SQSRD REF. SELF SERVE/DRY DUAL CASE



SQSRD 5448 DUAL CASE W/DRY SERVICE DISPLAY
 Refrigerated Service Top Display available - Model SQSRR

- SQSRD 3 36"L.X30"D.X54"H.
- SQSRD 4 48"L.X30"D.X54"H.
- SQSRD 5 60"L.X30"D.X54"H.
- SQSRD 6 72"L.X30"D.X58"H.
- SQSRD 8 96"L.X30"D.X58"H.

STANDARD FEATURES

DRY SECTION:

1. Top light.
2. Tilt forward front glass
3. Tempered glass top removable side glass gables.

REFRIGERATED SECTION:

1. Top light.
2. Stainless steel steps and interior components.
3. Exterior & interior finish Black
4. Self contained condensing unit.

OPTIONS:

- Exterior plastic laminate of choice.
- Stainless steel shelves.
- Stainless steel steps.
- Powder coated metal components.
- Custom units on request.
- Remote condensing unit.
- Electric condensate pan.

MODEL	DIMENSIONS	H.P.	ELECTRICAL			SHIPPING WT.
			COND. UNIT	LIGHTS	EVAPORATOR PAN (Optional)	
SQSRD 3	36"L.X30"D.X54"H.	1/2 H.P.	115V/1/60HZ/14.0 AMP	115V/1/60HZ/2.0 AMP	115V/1/60HZ/8.3 AMP	400 lb.
SQSRD 4	48"L.X30"D.X54"H.	3/4 H.P.	230V/1/60HZ/ 9.4 AMP	115V/1/60HZ/2.5 AMP	115V/1/60HZ/8.3 AMP	450 lb.
SQSRD 5	60"L.X30"D.X54"H.	3/4 H.P.	230V/1/60HZ/ 9.4 AMP	115V/1/60HZ/3.0 AMP	115V/1/60HZ/8.3 AMP	500 lb.
SQSRD 6	72"L.X30"D.X58"H.	1 1/4 H.P.	230V/1/60HZ/14.9 AMP	115V/1/60HZ/3.5 AMP	115V/1/60HZ/8.3 AMP	590 lb.
SQSRD 8	96"L.X30"D.X58"H.	1 1/4 H.P.	230V/1/60HZ/17.4 AMP	115V/1/60HZ/3.5 AMP	115V/1/60HZ/8.3 AMP	840 lb.

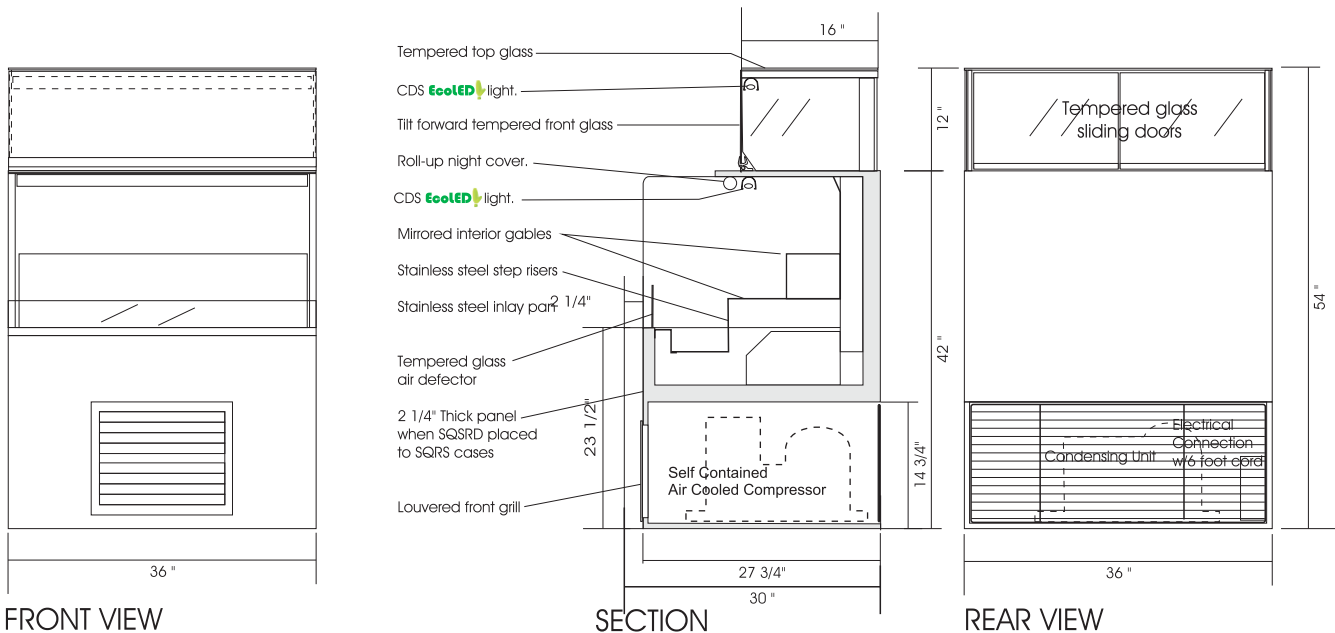

Operating temperature of 2° to 4° Celsius (37° to 40°F.) under normal store conditions of 24°C (75°F.) with 50% relative humidity.
 Condensation on glass may occur under hot & humid conditions.
 Product entering the display case must be 4°Celsius (40°F) or lower.

* Due to constant improvements, specifications are subject to change without notice.



Canadian Display Systems Inc.
 1-800-895-5862 (Toll Free)
cds1@on.aibn.com
www.canadiandisplayssystems.com

